



Reference <b>Airplane 91D Safir. Oil System</b> Introducing of non-return valve and modification of valve set.	Date March 26 1965	No. 91.4/7B	
	Saab Service Dept. B Carlsson <i>Blm</i> Saab Design. Dept. S Lundgren <i>Su</i>	Replace MB 91.4/7	
Urgency III	Royal Swedish Board of Civil Aviation S Fogelström <i>Su</i>		
Marking -	Effect on weight distribution		
	Weight change Lbs	Station In.	Moment change Lbsin.
	-	-	-

Time of delivery for necessary parts  
June 1965

Saab/C

Information:

The present system of venting the crankcase has caused sludge to form in the engine and cause corrosion of the valve tube. For this reason a non-return valve shall be introduced and the valve set changed.  
For aircraft, having the non-return valve fitted, a hose connection shall be introduced at the drain box in order to prevent the hose to seal against the bottom of the drain box with engine malfunction as a result.

Drawings: Not essential

Parts required per plane:

Item      Incl in figure 1

Alt I

01	1	Non-return valve	SA 9101306
02	1	Hose	1158717 ur
04	4	Hose clamp	AS 216521-5
05	2	Tape	1158721 ur
06	2	Button	SA 577436
13	1	Hose connection	SA 9101411
14	2	Lock nut	AS 215402-M4
15	2	Screw	AS 212116-M4x16

Alt II

07	1	T-fitting	1156741
	1	Plug	6105136

Alt III

08	1	Outlet cock	SA 9101195
07	1	T-fitting	1156741

Airplanes concerned:

Alt I

91310, 91347-91384, 91409-91444

Alt II

91347-91366, 91409-91418

Alt III

91367-91384

Alt IV

91347-91384

Spare parts involved:

Valve tube	1144649	} obsolete
Angle tube	1076015	

4335 IN 341201. 3. 62. 1000 4.12673

Alt IV

09 1 Valve tube 1156761

The following parts are obsolete:

Alt II 1 Angle tube 1076015

Alt IV 1 Valve tube 1144649

Work procedure:Alt IFigure 1

Remove existing hose between engine and oil tank and divide the hose so as two hoses item 03 L=185 mm are obtained.

Fit hoses item 03 and 02 and non-return valve item 01 with existing and new clamps item 04.

Drill two holes  $\phi$  4,3 in drain box after existing holes in hose connection item 13.

Fit hose connection item 13 with screws item 15 and nuts item 14.

Adjust hose item 02 to required length and fit it to the hose connection item 13.

Fit clamp item 4.

Tie hose item 02 to oil hose from oil cooler and drain hose from fuel pump with tape item 05 and button 06 according to figure.

Loosen tube item 10 and remove valve set item 11 and valve tube item 09.

Cut four grooves 3 mm in valve set item 11 according to figure 2.

Fit valve set with valve tube in the tank.

In airplane alt IV the new valve tube item 09 shall be fitted.

Refit the loosened tube item 10.

Besides the above the following must be added for.

Alt II

Remove existing angle tube on RH side and fit T-fitting item 07.

Move existing outlet cock item 08 from LH side to T-fitting item 07.

Fit plug in engine drain hole on LH side.

Fit existing hose item 12 to T-fitting item 07.

Alt III

Remove existing angle tube on RH side and fit T-fitting item 07.

Fit outlet cock item 08 to T-fitting item 07.

Fit existing hose item 12 to T-fitting item 07.



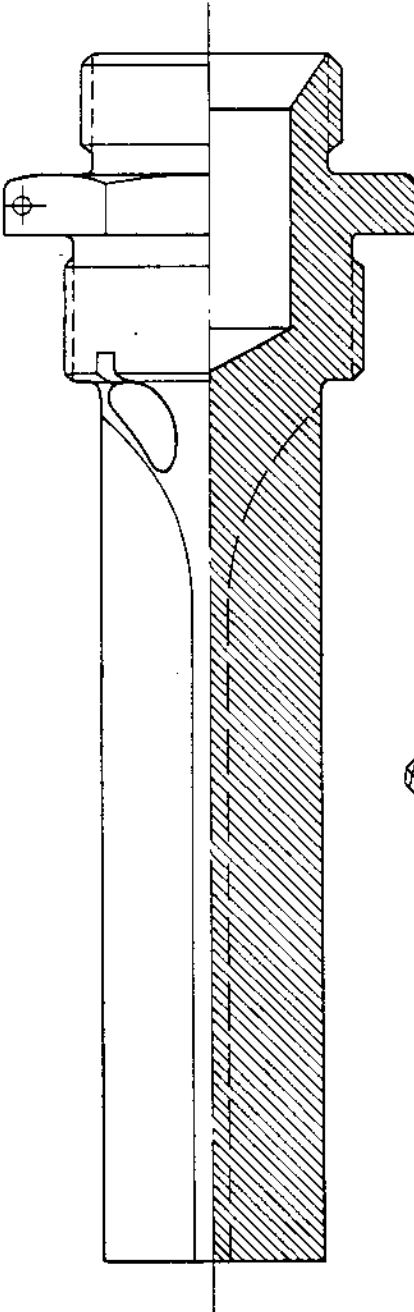
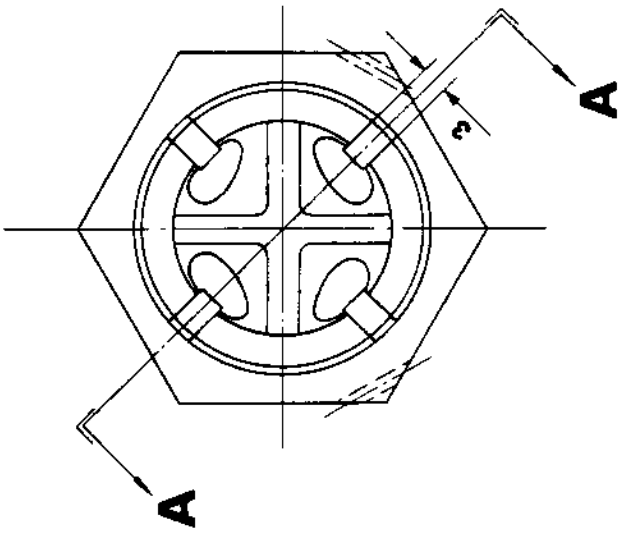
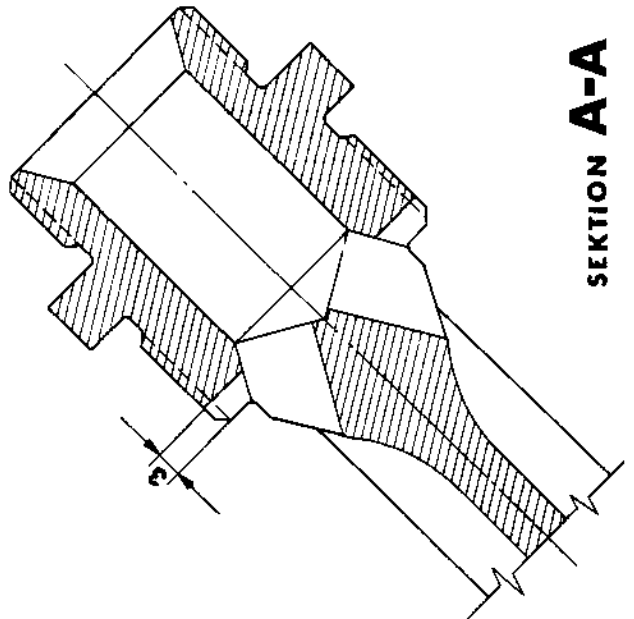

Fig 2



SEKSIÓN A-A